

Stainless steel industrial traction gas springs

Material 1.4301/1.4305, AISI 304/303 (V2A)
 Material 1.4404/1.4571, AISI 316L/316Ti (V4A)

In addition to the comprehensive range of industrial gas springs with valve, ACE also offers a wide range of industrial traction gas springs made of stainless steel with body diameters from 15 mm to 40 mm. This high-quality version is also available on request in all stroke lengths and possible extension forces. The comprehensive range of fitting parts ensures easy installation and makes the gas traction springs universal in use. Stainless steel traction gas springs are used everywhere that raising and lowering is required. Due to their special properties, **non-rusting and low magnetism**, they are the preferred equipment for medical and clean-room technology, the foodstuffs industry, electronics and shipbuilding sector.

NEW

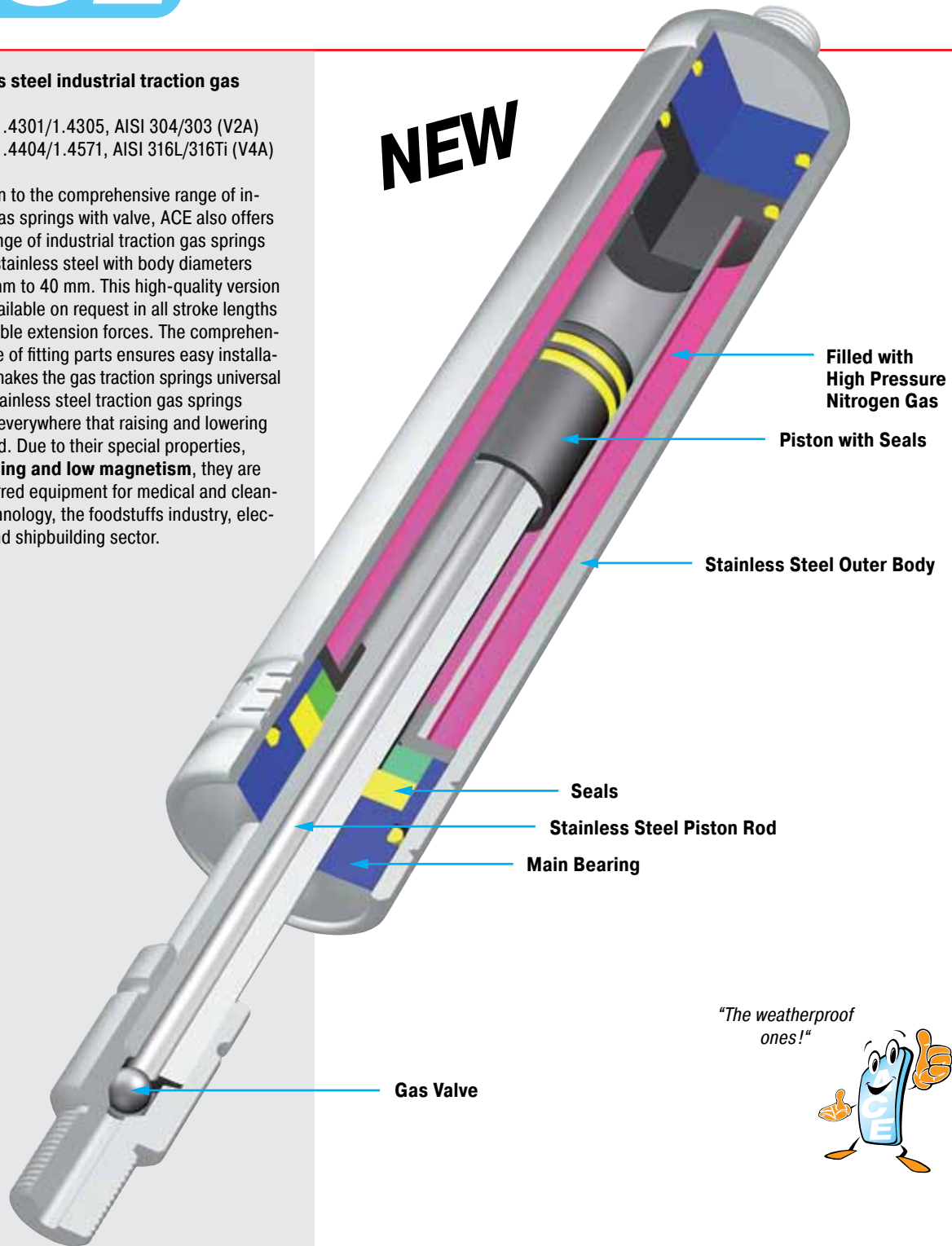

"The weatherproof ones!"



Issue 6.2011 Specifications subject to change

Operating fluid: Nitrogen gas

Material: Piston rod, body and end fittings: Material 1.4301/1.4305, AISI 304/303 (V2A) and material 1.4404/1.4571, AISI 316L/316Ti (V4A).

Mounting: In any position

Operating temperature range:
 -20 °C to 80 °C

On request: Special force curves, special lengths, alternative seals, wiper.



Traction (Pull) Forces 50 N to 300 N
(when Piston Rod Extended up to 370 N)

NEW

End Fitting

Standard Dimensions

End Fitting

B3,5

A3,5-V4A

C3,5-V4A

D3,5-V4A

G3,5-V4A

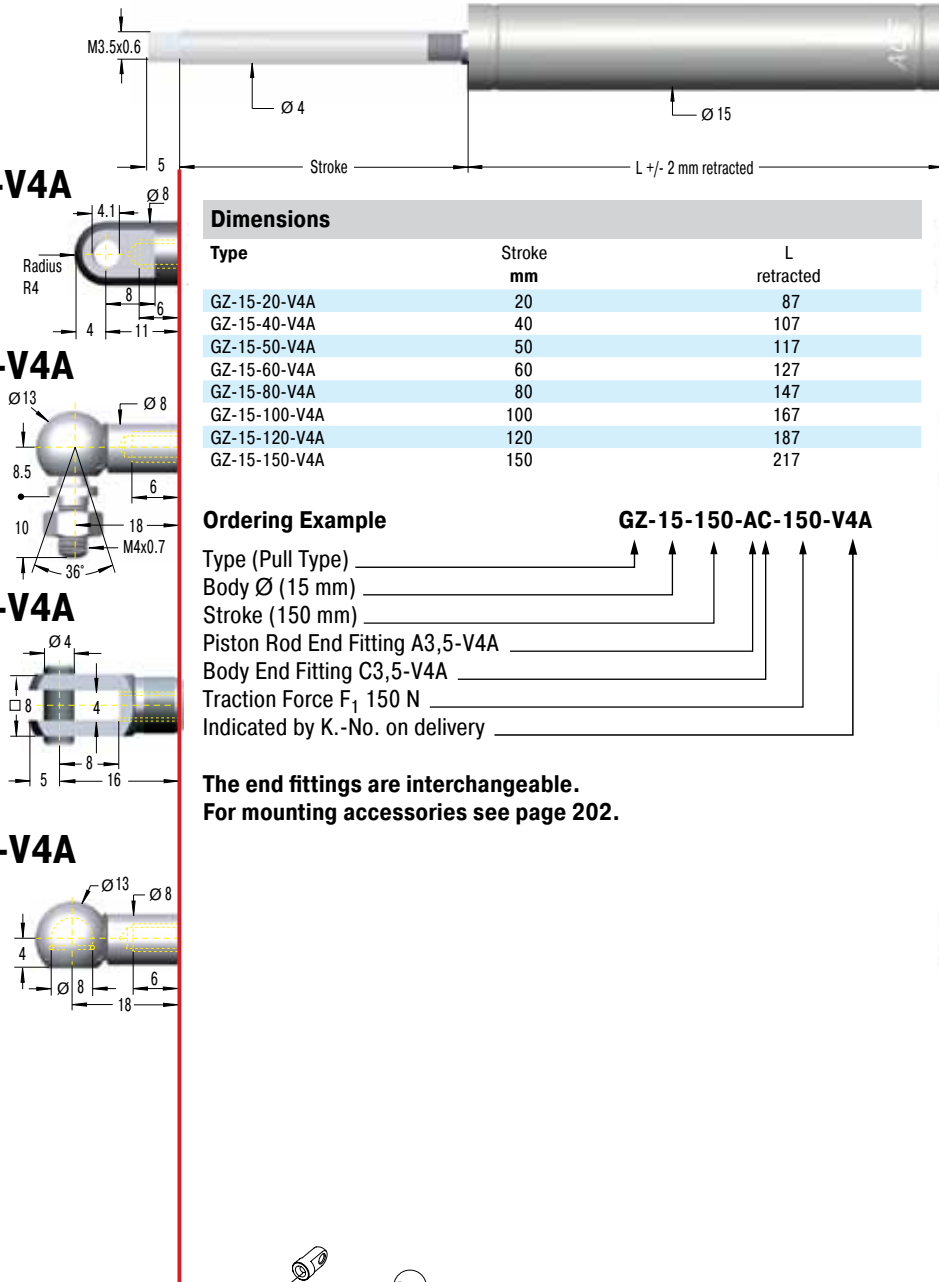

Stud Thread **B3,5**

A3,5-V4A
Eye
max. force 370 N

C3,5-V4A
Angle Ball Joint
max. force 370 N

D3,5-V4A
Clevis Fork
max. force 370 N

G3,5-V4A
Ball Socket
max. force 370 N

Adjuster Knob U3,5
See page 163.

Dimensions

Type	Stroke mm	L retracted
GZ-15-20-V4A	20	87
GZ-15-40-V4A	40	107
GZ-15-50-V4A	50	117
GZ-15-60-V4A	60	127
GZ-15-80-V4A	80	147
GZ-15-100-V4A	100	167
GZ-15-120-V4A	120	187
GZ-15-150-V4A	150	217

Ordering Example

GZ-15-150-AC-150-V4A

Type (Pull Type) _____
 Body Ø (15 mm) _____
 Stroke (150 mm) _____
 Piston Rod End Fitting A3,5-V4A _____
 Body End Fitting C3,5-V4A _____
 Traction Force F_1 150 N _____
 Indicated by K.-No. on delivery _____

The end fittings are interchangeable.
For mounting accessories see page 202.

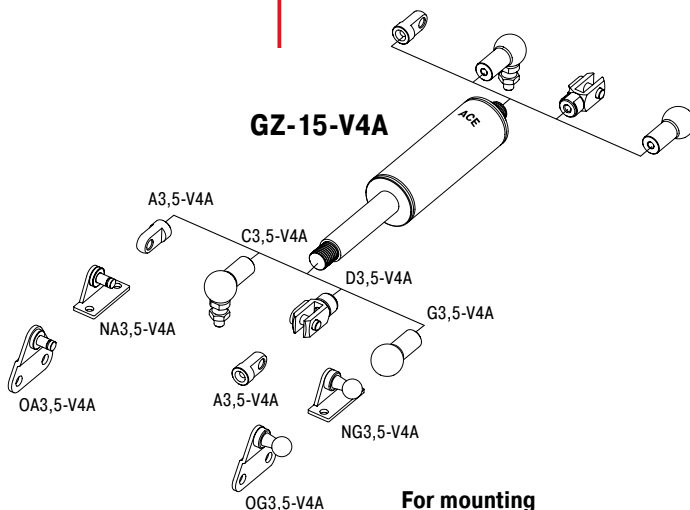

For mounting
accessories
see page 202.

Technical Data

On request: Special force curves, special lengths, alternative end fittings, rod shroud.

Mounting: In any position. Install mechanical stop in extended position.

End position damping length: Without damping

Material: Piston rod, body and end fittings: Material 1.4571/1.4404, AISI 316L/316Ti (V4A).

Progression: approx. 23 %, F_2 max. 370 N

Available traction force range F_1 at 20 °C: 50 N to 300 N

Note: Lifetime approx. 2000 m

Traction (Pull) Forces 30 N to 300 N
(when Piston Rod Extended up to 333 N)

NEW

End Fitting

Standard Dimensions

End Fitting

B8

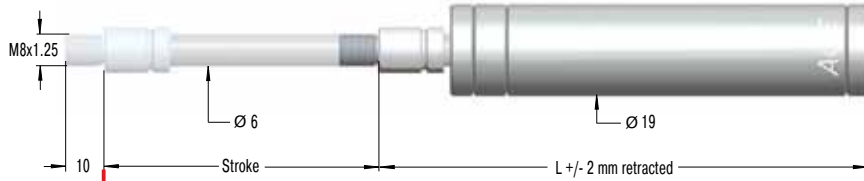

Stud Thread **B8**

A8-VA

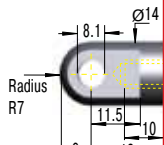

Eye
A8-VA
max. force 1560 N

C8-VA

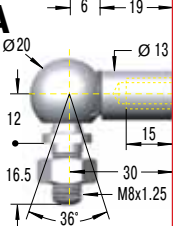

Angle Ball Joint
C8-VA
max. force 1140 N

D8-VA

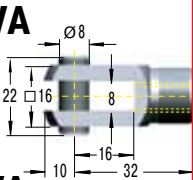

Clevis Fork
D8-VA
max. force 1560 N

E8-VA

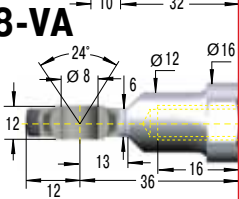

Swivel Eye
E8-VA
max. force 1560 N

G8-VA

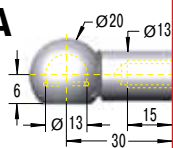

Ball Socket
G8-VA
max. force 1140 N

Rod Shroud
W8-19-VA

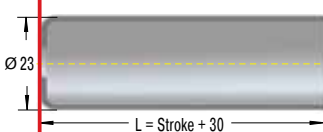

Dimensions

Type	Stroke mm	L retracted
GZ-19-30-VA	30	130
GZ-19-50-VA	50	150
GZ-19-100-VA	100	200
GZ-19-150-VA	150	250
GZ-19-200-VA	200	300
GZ-19-250-VA	250	350

Ordering Example

GZ-19-150-AC-150-VA

Type (Pull Type) _____
 Body Ø (19 mm) _____
 Stroke (150 mm) _____
 Piston Rod End Fitting A8-VA _____
 Body End Fitting C8-VA _____
 Traction Force F_1 150 N _____
 Indicated by K.-No. on delivery _____

The end fittings are interchangeable.
For mounting accessories see page 203.

Adjuster Knob
UZ8

See page 163.

GZ-19-VA

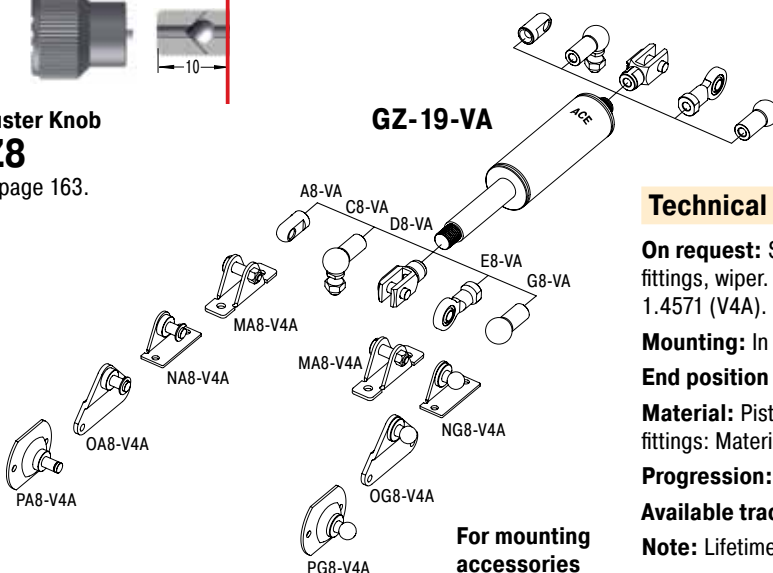

For mounting
accessories
see page 203.

Technical Data

On request: Special force curves, special lengths, alternative end fittings, wiper. Gas springs and accessories with material 1.4404/1.4571 (V4A).

Mounting: In any position. Install mechanical stop in extended position.

End position damping length: Without damping

Material: Piston rod: Material 1.4401, AISI 316L (V4A). Body and end fittings: Material 1.4301, AISI 304 (V2A).

Progression: Approx. 11%, F_2 max. 333 N

Available traction force range F_1 at 20 °C: 30 N to 300 N

Note: Lifetime approx. 2000 m

Traction (Pull) Forces 150 N to 1200 N
(when Piston Rod Extended up to 1460 N)

NEW

End Fitting

Standard Dimensions

End Fitting

B10

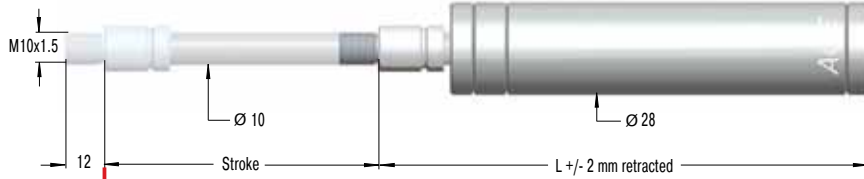

Stud Thread **B10**

A10-VA

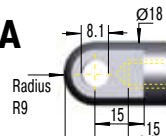

Eye A10-VA
max. force 3800 N

C10-VA

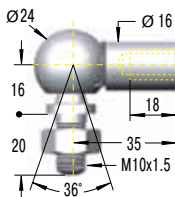

Angle Ball Joint C10-VA
max. force 1750 N

D10-VA

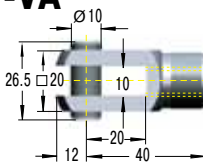

Clevis Fork D10-VA
max. force 3800 N

E10-VA

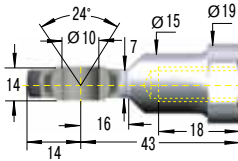

Swivel Eye E10-VA
max. force 3800 N

Dimensions

Type	Stroke mm	L retracted
GZ-28-50-VA	50	165
GZ-28-100-VA	100	215
GZ-28-150-VA	150	265
GZ-28-200-VA	200	315
GZ-28-250-VA	250	365
GZ-28-300-VA	300	415
GZ-28-350-VA	350	465
GZ-28-400-VA	400	515
GZ-28-450-VA	450	565
GZ-28-500-VA	500	615
GZ-28-550-VA	550	665
GZ-28-600-VA	600	715

Ordering Example

GZ-28-150-EE-800-VA

Type (Pull Type) _____
 Body Ø (28 mm) _____
 Stroke (150 mm) _____
 Piston Rod End Fitting E10-VA _____
 Body End Fitting E10-VA _____
 Traction Force F₁ 800 N _____
 Indicated by K.-No. on delivery _____

The end fittings are interchangeable.
For mounting accessories see page 203.

Rod Shroud

W10-28-VA

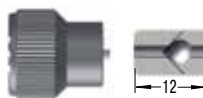
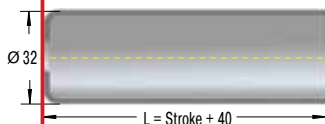

Adjuster Knob

UZ10

See page 163.

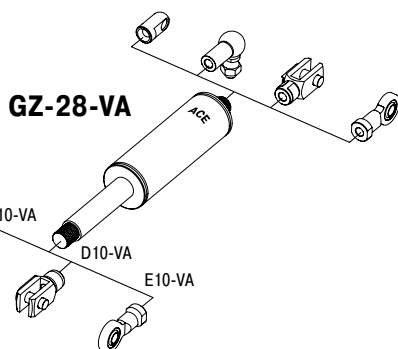

For mounting accessories see page 203.

Technical Data

On request: Special force curves, special lengths, alternative end fittings, wiper. Gas springs and accessories with material 1.4404/1.4571 (V4A).

Mounting: In any position. Install mechanical stop in extended position.

End position damping length: Without damping

Material: Piston rod, body and end fittings: Material 1.4301/1.4305, AISI 304/303 (V2A).

Progression: Approx. 22%, F₂ max. 1460 N

Available traction force range F₁ at 20 °C: 150 N to 1200 N

Note: Lifetime approx. 2000 m

Traction (Pull) Forces 400 N to 5000 N
(when Piston Rod Extended up to 7000 N)

NEW

End Fitting

Standard Dimensions

End Fitting

B14



Stud Thread **B14**

A14-VA

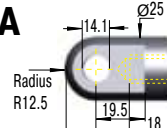

Dimensions

Type	Stroke mm	L retracted
GZ-40-100-VA	100	250
GZ-40-150-VA	150	325
GZ-40-200-VA	200	400
GZ-40-250-VA	250	475
GZ-40-300-VA	300	550
GZ-40-400-VA	400	700
GZ-40-500-VA	500	850
GZ-40-600-VA	600	1 000

Eye
A14-VA
max. force 7000 N

C14-VA

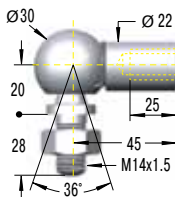

Angle Ball Joint
C14-VA
max. force 3200 N

D14-VA

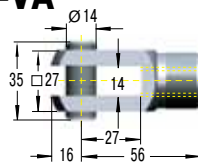

Clevis Fork
D14-VA
max. force 7000 N

E14-VA

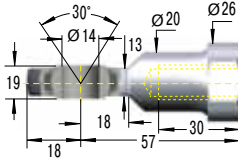

Swivel Eye
E14-VA
max. force 7000 N

Ordering Example

GZ-40-150-EE-800-VA

Type (Pull Type) _____
 Body Ø (40 mm) _____
 Stroke (150 mm) _____
 Piston Rod End Fitting E14-VA _____
 Body End Fitting E14-VA _____
 Traction Force F₁ 800 N _____
 Indicated by K.-No. on delivery _____

The end fittings are interchangeable.
For mounting accessories see page 204.

Rod Shroud
W14-40-VA

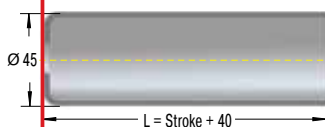

Adjuster Knob

UZ14

See page 163.

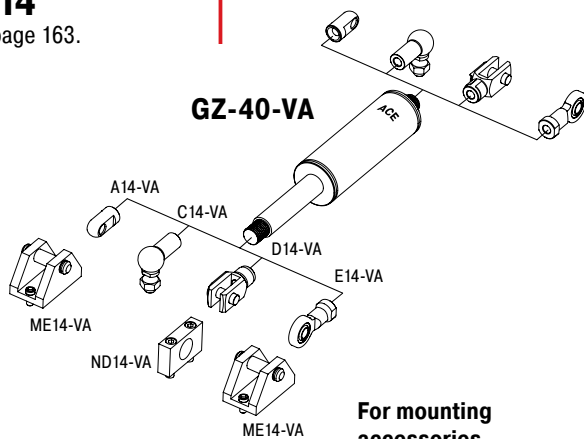

For mounting
accessories
see page 204.

Technical Data

On request: Special force curves, special lengths, alternative end fittings, wiper. Gas springs and accessories with material 1.4404/1.4571 (V4A).

Mounting: In any position. Install mechanical stop in extended position.

End position damping length: Without damping

Material: Piston rod, body and end fittings: Material 1.4301/1.4305, AISI 304/303 (V2A).

Progression: Approx. 40%, F₂ max. 7000 N

Available traction force range F₁ at 20 °C: 400 N to 5000 N

Note: Lifetime approx. 2000 m